

Description

Nylon anchor for hollow and solid material

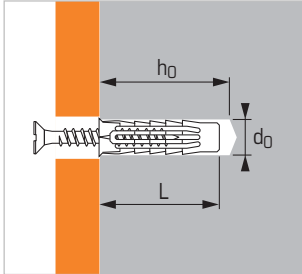

Applications

- Lightweight fixing in all base material
- Small electrical accessories, small light fittings, fuse boxes, etc...

Material

- Body: polyamid 6
Suitable temperature - 20° + 40°C
- Screw : Special screw supplied, head type PZ2

Installation

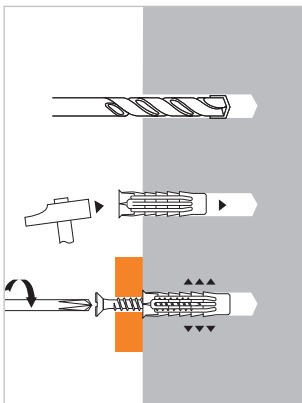

Technical Data

Part No.	Anchor Size (mm)	Screw diameter (mm)	Drilling depth (mm) h ₀	Drilling diameter (mm) d ₀	Total anchor length (mm) L	Order Qty (mm)	
without screw	with VBA screw						
565642	565646	5X25	3-4	35	5	25	100
565643	565647	6X30	4-5	40	6	30	100
565644	565648	8X40	4.5-6	50	8	40	100
565645	565649	10X50	6-8	65	10	50	50
565617	-	12X60	8-10	75	12	60	25
565618	-	14X70	10-12	85	14	70	20

Recommended Load (N_{rec}) and Ultimate Load (N_{Ru,m}) in kN with wood screw

TENSILE

Base material	Anchor size	Screw Ø	Ø5	Ø6	Ø8	Ø10
			4	5	6	8
Concrete (>C20/25)						
N _{rec} *			0,28	0,28	0,50	0,70
N _{Ru,m} *			1,40	1,40	2,50	3,50
Hollow concrete blocks B 40						
N _{rec} *			0,23	0,3	0,43	0,46
N _{Ru,m} *			1,15	1,5	2,15	2,30
Clay bricks BP 40						
N _{rec} *			0,20	0,26	0,35	0,60
N _{Ru,m} *			1,00	1,30	1,75	3,00
Hollow clay bricks Eco 40						
N _{rec} *			0,17	0,19	0,23	0,25
N _{Ru,m} *			0,85	0,95	1,15	1,25

* Indicative values : depending on the type of screw used, the loads must be reduce by 50 %

